

TECHNICAL DATA SHEET

**F - 450 - 001
MASONRY MULTI-
PROFILE FRAME**

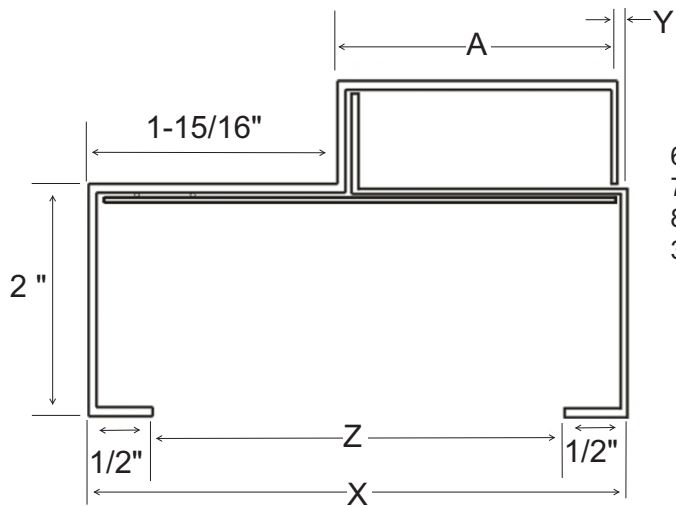

SIZES AVAILABLE
68 WITH HDW PREPS.
70 WITH HDW PREPS.
80 WITH NO HDW PREPS.
30 & 60 HEADERS

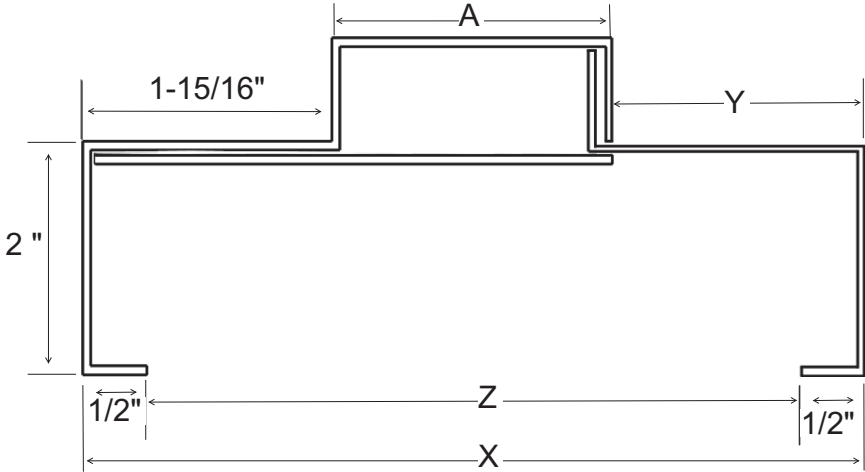

ORDER SIZE	PROFILE DEPTH X		VARIABLE RABBET Y		VARIABLE THROAT Z		SOFFIT A
	MIN	MAX	MIN	MAX	MIN	MAX	
4 3/4" - 7 1/4"	4 3/4"	7 1/4"	1/16"	2 9/16"	3 3/4"	6 1/4"	2 3/4"
5 3/8" - 8 1/2"	5 3/8"	8 1/2"	1/16"	3 3/16"	4 3/8"	7 1/2"	3 3/8"
8 1/2" - 14 3/4"	8 1/2"	14 3/4"	1/16"	6 5/16"	7 1/2"	13 3/4"	6 1/2"

Issue Date: July 2009

REVISED : 02/01/2009



TECHNICAL DATA SHEET

F - 450 - 001
MASONRY MULTI-
PROFILE FRAME

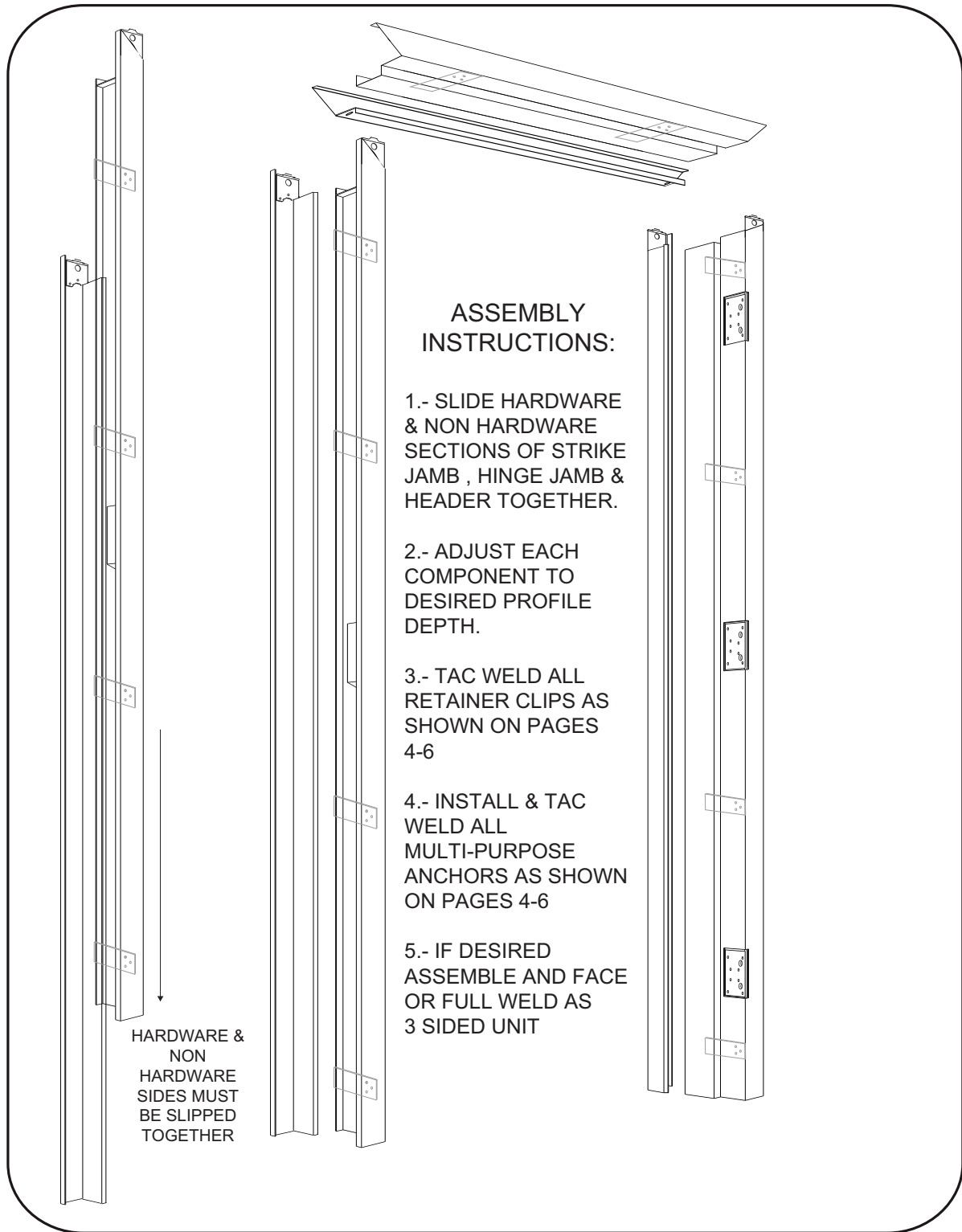

ASSEMBLY INSTRUCTIONS:

- 1.- SLIDE HARDWARE & NON HARDWARE SECTIONS OF STRIKE JAMB , HINGE JAMB & HEADER TOGETHER.
- 2.- ADJUST EACH COMPONENT TO DESIRED PROFILE DEPTH.
- 3.- TAC WELD ALL RETAINER CLIPS AS SHOWN ON PAGES 4-6
- 4.- INSTALL & TAC WELD ALL MULTI-PURPOSE ANCHORS AS SHOWN ON PAGES 4-6
- 5.- IF DESIRED ASSEMBLE AND FACE OR FULL WELD AS 3 SIDED UNIT

HARDWARE & NON HARDWARE SIDES MUST BE SLIPPED TOGETHER

PAGE 2/6

Issue Date: July 2009

REVISED : 02/01/2009



TECHNICAL DATA SHEET

F - 450 - 001 MASONRY MULTI- PROFILE FRAME

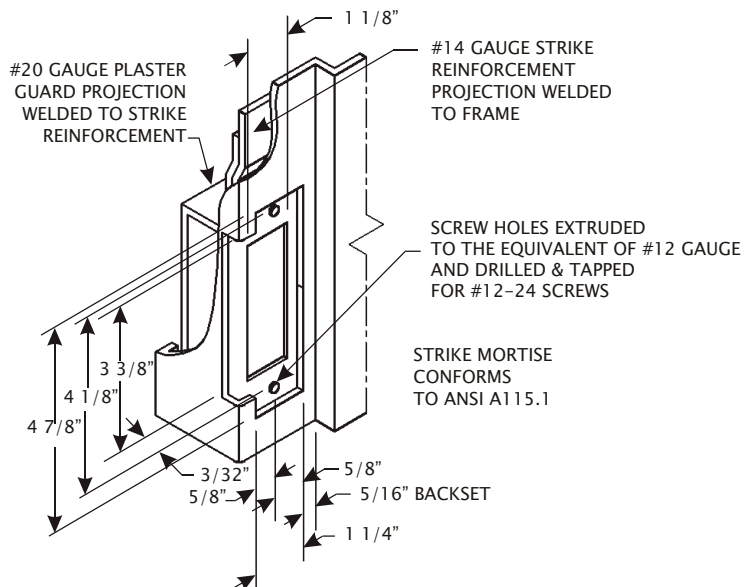
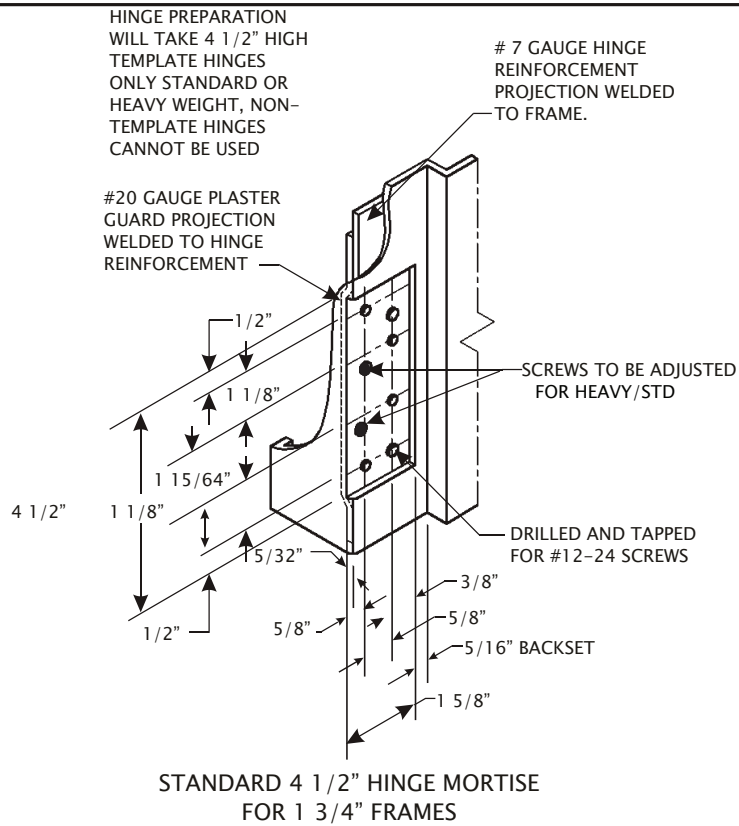

ANSI A 115

Issue Date: July 2009

REVISED : 02/01/2009



TECHNICAL DATA SHEET

F - 450 - 001 MASONRY MULTI- PROFILE FRAME

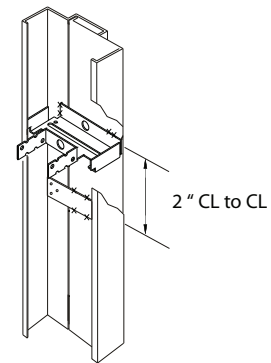
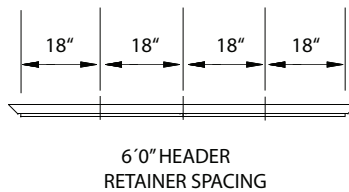
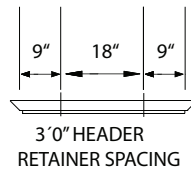
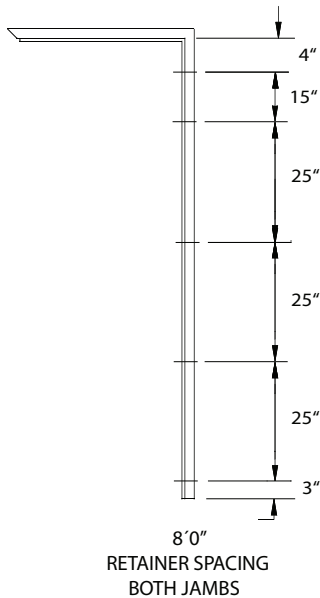
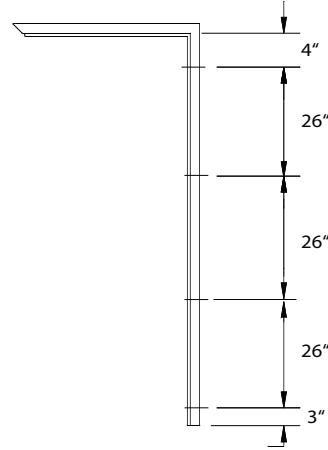
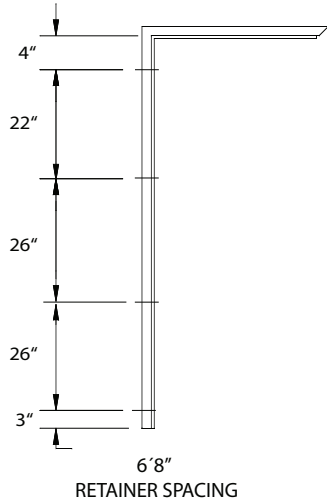

RETAINER CLIPS AND MULTI-PURPOSE ANCHORS PLACEMENT NOTE:

A RETAINER AND A MULTI-PURPOSE ANCHOR MUST BE USED FOR EACH 30 INCHES OF JAMB HEIGHT OR FRACTION THEREOF. ON THE HINGE JAMB, EACH RETAINER AND MULTI-PURPOSE ANCHORS MUST BE LOCATED IMMEDIATELY ABOVE OR BELOW EACH HINGE REINFORCEMENT. ON THE STRIKE JAMB, RETAINERS MULTI-PURPOSE ANCHORS MUST BE LOCATED DIRECTLY OPPOSITE THE RETAINERS AND MULTI-PURPOSE ANCHORS OF THE HINGE JAMB, MULTI-PURPOSE ANCHORS MUST BE WELDED NO MORE THAN 2 1/4" CL TO CL OVER THE RETAINERS LOCATIONS

PAGE 4/6

Issue Date: July 2009

REVISED : 02/01/2009



TECHNICAL DATA SHEET

F - 450 - 001 MASONRY MULTI- PROFILE FRAME

16 GAUGE FRAME UNIT

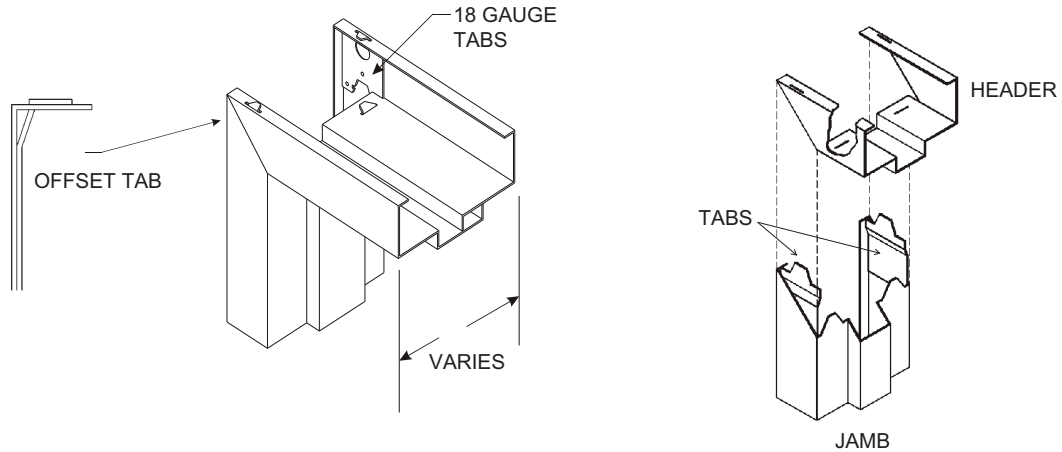

ALL 68 & 70 UPRIGHTS ARE PROVIDED WITH FOUR 14 GA RETAINER CLIPS

ALL 80 UPRIGHTS ARE PROVIDED WITH FIVE 14 GA RETAINER CLIPS

ALL 30 HEADERS ARE PROVIDED WITH TWO 14 GA RETAINER CLIPS

ALL 60 HEADERS ARE PROVIDED WITH THREE 14 GA RETAINER CLIPS

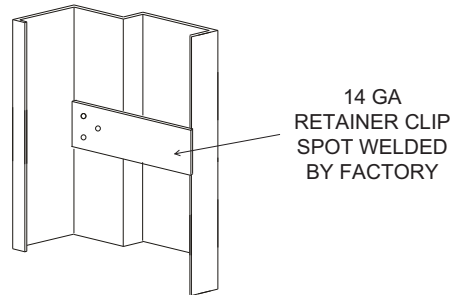
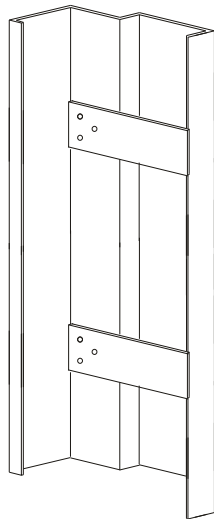

TECHNICAL DATA SHEET

F - 450 - 001 MASONRY MULTI- PROFILE FRAME

MULTI-PURPOSE ANCHOR 16 GAUGE REINF.

TO INSTALL

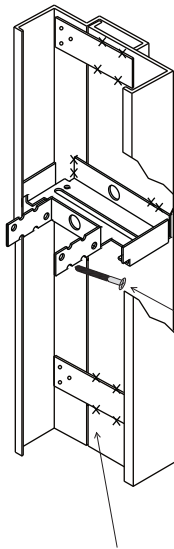

AFTER DESIRED PROFILE HAS BEEN ACHIVED AND THE 14GA RETAINER CLIPS HAVE BEEN TAC WELDED IT IS THE CUSTOMERS RESPONSABILITY TO TAC WELD MULTI-PURPOSE ANCHORS TO BOTH RABBETS IN EACH UPRIGHT FOR RIGIDITY

SCREW INFORMATION:

FOR WOOD STUD : A MINIMUM OF 4 SCREWS, 2 PER SIDE
8D BOX NAILS

FOR METAL STUD: A MINIMUM OF 4 SCREWS, 2 PER SIDE
PAN + WASHER HEAD # 8 STEEL SCREW

IF PROFILE DEPTH IS LARGER THAN 5 3/4 SNAP TOGHTER AND INSTALL TWO MULTI-PURPOSE ANCHORS TO BE ABLE TO WELD TO BOTH RABBETS IN EACH UPRIGHT FOR RIGIDITY

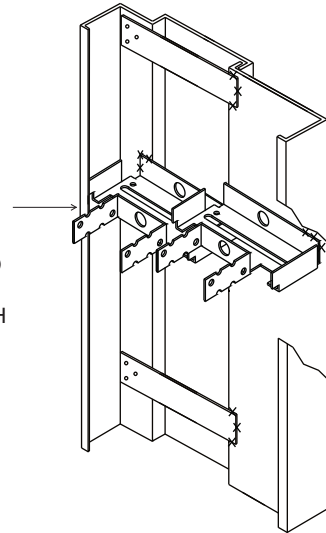

AFTER DESIRED PROFILE HAS BEEN ACHIVED IT IS THE CUSTOMERS RESPONSABILITY TO TAC WELD ALL 14 GA RETAINER CLIPS WITH FOUR 1/4 " TAC WELDS

NOTE:

MULTI-PURPOSE ANCHORS MUST ALWAYS BE WELDED IN. IF ANOTHER ANCHOR TYPE SUCH AS MASONRY "T" MASONRY WIRE OR EXISTING WALL ANCHOR IS REQUIRED EITHER BEND OR REMOVE THE STRAPS ON THE MULTI-PURPOSE ANCHORS.

1.- FORM STRAPS TO FIT STUD

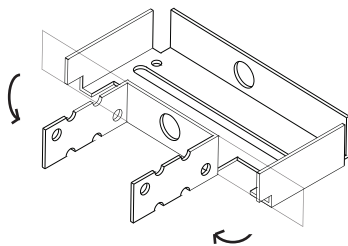

OPTIONAL: STEEL STUD ANCHOR 16 GA REINFORCEMENT CAN BE USE INSTED THE MULTI-PUPOSE ANCHOR.

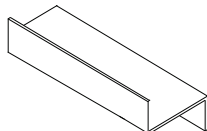

2.- INSERT ANCHOR IN FRAME IN VERTICAL POSITION AND TURN 90°

